

CITY OF SAN BERNARDINO
PROPERTY

HIGHLAND

VALENCIA AVE.

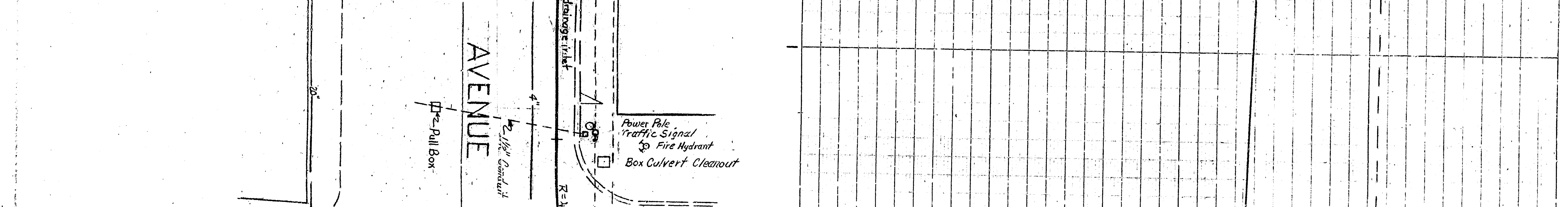
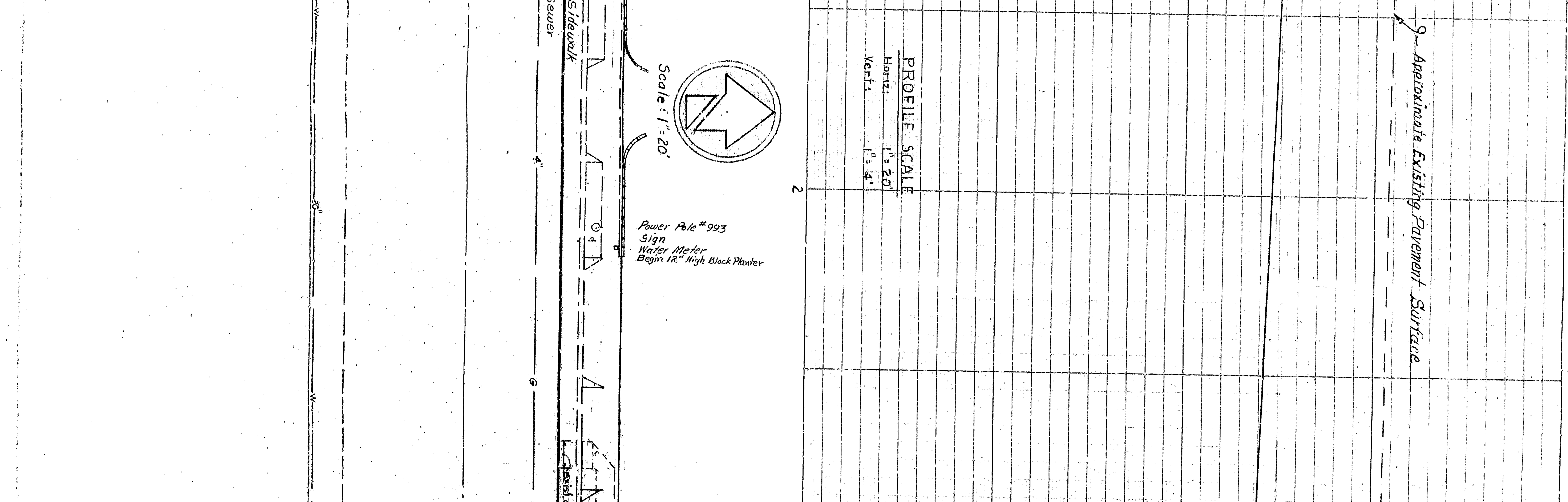
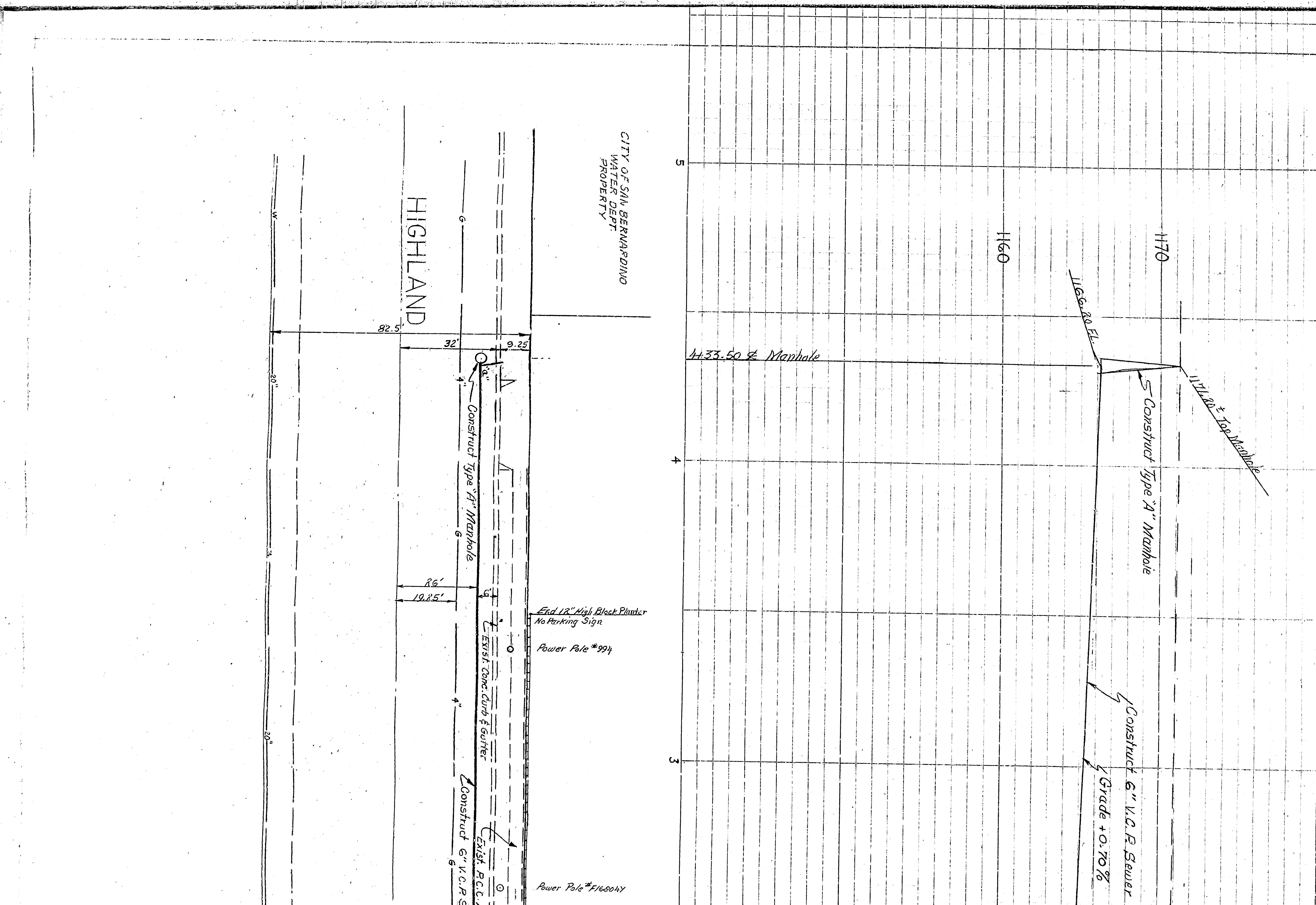

PROFILE SCALE
 Horiz. 1" = 20'
 Vert. 1" = 4'

Scale: 1" = 20'

Power Pole #991
 Sign: 12" High Black Plaque
 No Parking Sign

Power Pole #992
 Sign: Water Meter
 Begin 12" High Black Plaque

Power Pole #993
 Sign: Water Meter
 Begin 12" High Black Plaque

Power Pole #994
 Sign: Traffic Signal
 Fire Hydrant
 Box Culvert Clearance

Power Pole #995
 Sign: Traffic Signal
 Fire Hydrant
 Box Culvert Clearance

GENERAL NOTES

- All work symbolized on this plan shall be done in accordance with the provisions of Standard Specifications for Highway Construction, 1965 and on those connecting sewer lines be constructed in accordance with the provisions of the City of San Bernardino.
- Construct Type A Manhole shall be constructed of either 12" or 18" diameter concrete pipe.
- Construct Type B Manhole shall be constructed of either 12" or 18" diameter concrete pipe.
- Construct Type C Manhole shall be constructed of either 12" or 18" diameter concrete pipe.
- Construct Type D Manhole shall be constructed of either 12" or 18" diameter concrete pipe.
- Construct Type E Manhole shall be constructed of either 12" or 18" diameter concrete pipe.
- Construct Type F Manhole shall be constructed of either 12" or 18" diameter concrete pipe.
- Construct Type G Manhole shall be constructed of either 12" or 18" diameter concrete pipe.
- Construct Type H Manhole shall be constructed of either 12" or 18" diameter concrete pipe.
- Construct Type I Manhole shall be constructed of either 12" or 18" diameter concrete pipe.
- Construct Type J Manhole shall be constructed of either 12" or 18" diameter concrete pipe.
- Construct Type K Manhole shall be constructed of either 12" or 18" diameter concrete pipe.
- Construct Type L Manhole shall be constructed of either 12" or 18" diameter concrete pipe.
- Construct Type M Manhole shall be constructed of either 12" or 18" diameter concrete pipe.
- Construct Type N Manhole shall be constructed of either 12" or 18" diameter concrete pipe.
- Construct Type O Manhole shall be constructed of either 12" or 18" diameter concrete pipe.
- Construct Type P Manhole shall be constructed of either 12" or 18" diameter concrete pipe.
- Construct Type Q Manhole shall be constructed of either 12" or 18" diameter concrete pipe.
- Construct Type R Manhole shall be constructed of either 12" or 18" diameter concrete pipe.
- Construct Type S Manhole shall be constructed of either 12" or 18" diameter concrete pipe.
- Construct Type T Manhole shall be constructed of either 12" or 18" diameter concrete pipe.
- Construct Type U Manhole shall be constructed of either 12" or 18" diameter concrete pipe.
- Construct Type V Manhole shall be constructed of either 12" or 18" diameter concrete pipe.
- Construct Type W Manhole shall be constructed of either 12" or 18" diameter concrete pipe.
- Construct Type X Manhole shall be constructed of either 12" or 18" diameter concrete pipe.
- Construct Type Y Manhole shall be constructed of either 12" or 18" diameter concrete pipe.
- Construct Type Z Manhole shall be constructed of either 12" or 18" diameter concrete pipe.

APPROVED [Signature] 2-9-67
 CITY ENGINEER
 CITY OF SAN BERNARDINO

CHECKED BY [Signature]
 REGISTERED CIVIL ENGINEER NO. 13453
 3566
 SHEET 1 OF 5 SHEETS

RECOMMENDED BY [Signature]
 REGISTERED CIVIL ENGINEER NO. 13453
 3566
 SHEET 1 OF 5 SHEETS

FROM VALENCIA AVE TO A POINT 433' WEST